



Fast-build panel EVOLUTION

Assembly instructions



United in panels.



Fast-Build Walk-In **EVOLUTION**

Packaging and tools

For protection during transport, the fast-build panels **EVOLUTION** are delivered wrapped in film and with edge protectors on a pallet. When cutting open the film, please ensure not to damage the panel surface.



The following tools are required for the assembly of **EVOLUTION**:

1. Spirit level
2. Measuring tape
3. Knife
4. Pencil
5. Lock cell key (included in the scope of delivery)

Optionally, you can also use a leveling laser (6.) and a chalk line (7.) for assembly and seal the joints using a cartridge gun (8.). In addition, you should adjust the door and the lock, as they are only roughly preadjusted prior to delivery. To do so, you need a screwdriver and a socket wrench with an SW 10 bit (socket).





Overview - Assembly steps

1.	Assembly of frost heave prevention heating (optional)	Page 5
2.	Lay compensation plates	Page 6
3.	Assembly of floor panels	Page 7
4.	Assembly of wall panels	Page 8
5.	Assembly of ceiling	Page 10
6.	Remove protective film	Page 10
7.	Cover caps	Page 10
8.	Control box (optional)	Page 11
9.	Pressure compensation valve (standard), heating for revolving freezer door & light (both optional)	Page 12
10.	Door and lock	Page 12
11.	Seal joints (optional)	Page 14
12.	Remove protective film	Page 14
13.	Position access ramp (optional)	Page 15



Fast-Build Walk-In **EVOLUTION**

Assembly

The scope of delivery includes a cell plan showing how to assemble the cell. Each panel is delivered with a label, indicating where to place it.

TIP: Ensure a minimum distance of 10 cm to the surrounding walls!



1. Assembly of frost heave prevention heating (optional)

Freezer cells may require frost heave prevention heating; please consult a construction physicist in advance. If no heating is required, you can skip this step!

The length of the frost heave prevention heating is calculated based on the size of the freezer cell and supplied in the suitable length. The heating is delivered on a reel which can be temporarily fastened to the floor with adhesive tape to keep it in the proper position. To achieve the pattern shown in the figure, it has proved useful to make two incisions at the corner of the transparent film of the heating. In the process, please ensure that the heating wires are not positioned crosswise and that the mats are not positioned on top of each other! A gap of 30-40 cm between the heating film webs should be ensured. Once the heating is in the proper position, the heating sensors are fastened with adhesive tape in the center.

TIP: Position the heating in such a way that the cold cables run under the cell in the position where the control box will also be attached later!

Laying of the frost heave prevention heating

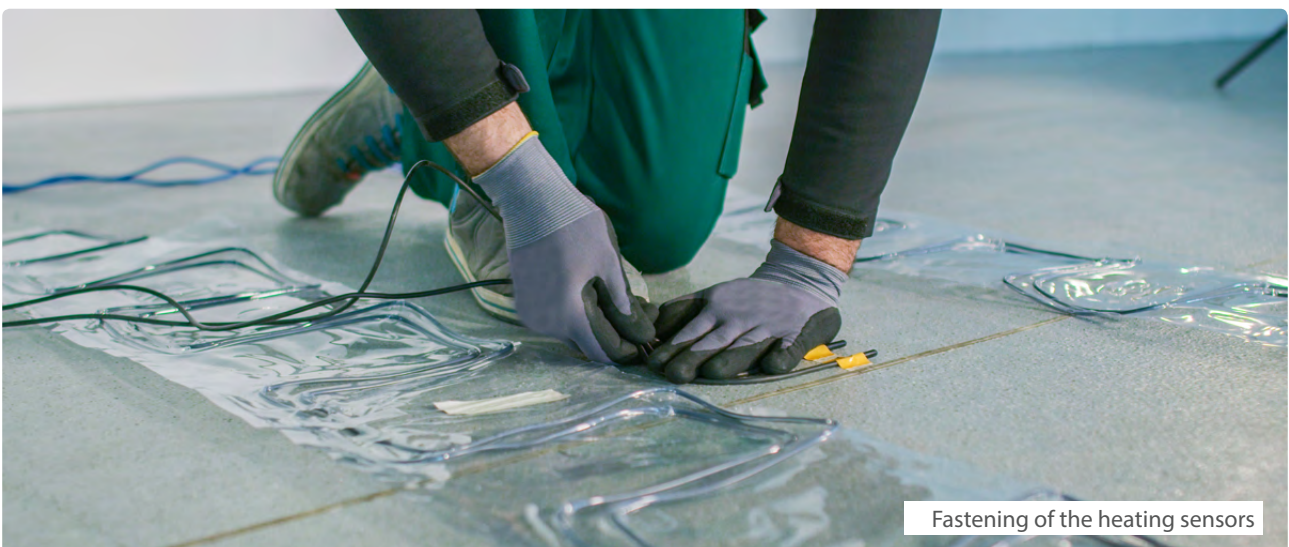

Fastening of the heating sensors



Fast-Build Walk-In **EVOLUTION**

2. Lay compensation plates

To guarantee the ventilation of the floor panels and to compensate for floor unevenness, the compensation plates are required. The position of the plates is determined by the plan included in the scope of delivery and must be followed to the letter. In the process, you must ensure that the plates do not rest on the wires of the frost heave prevention heating; otherwise there is a risk of crushing the wires. Smaller unevennesses can be compensated for with thin metal plates or the like. Use a spirit level or leveling laser to determine how much you need to compensate for.

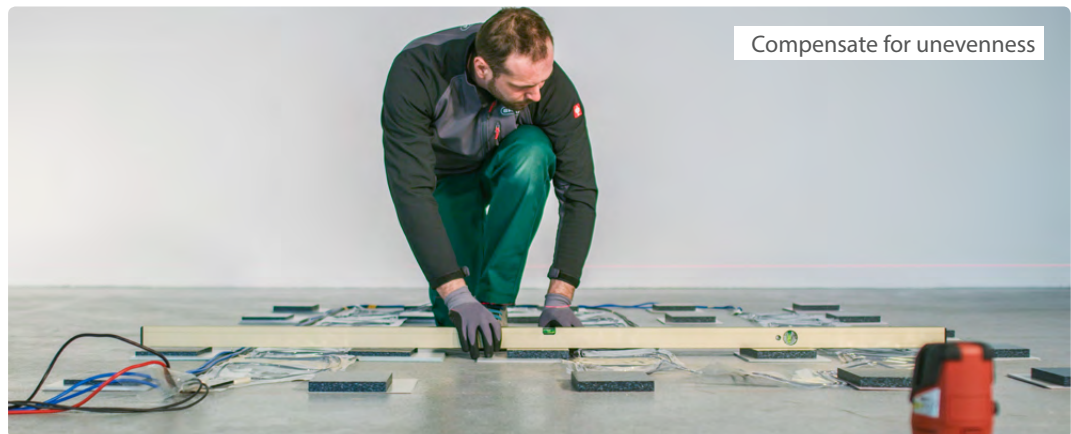

3. Assembly of floor panels

To begin with, the floor panels are laid as per the cell plan, pushed together and locked using the lock cell key.

TIP: Prior to pushing the panels together, it is recommended to already remove a couple of centimeters of the protective film; this will facilitate the later removal of the protective film. The remaining film will protect the floor against becoming dirty during assembly.

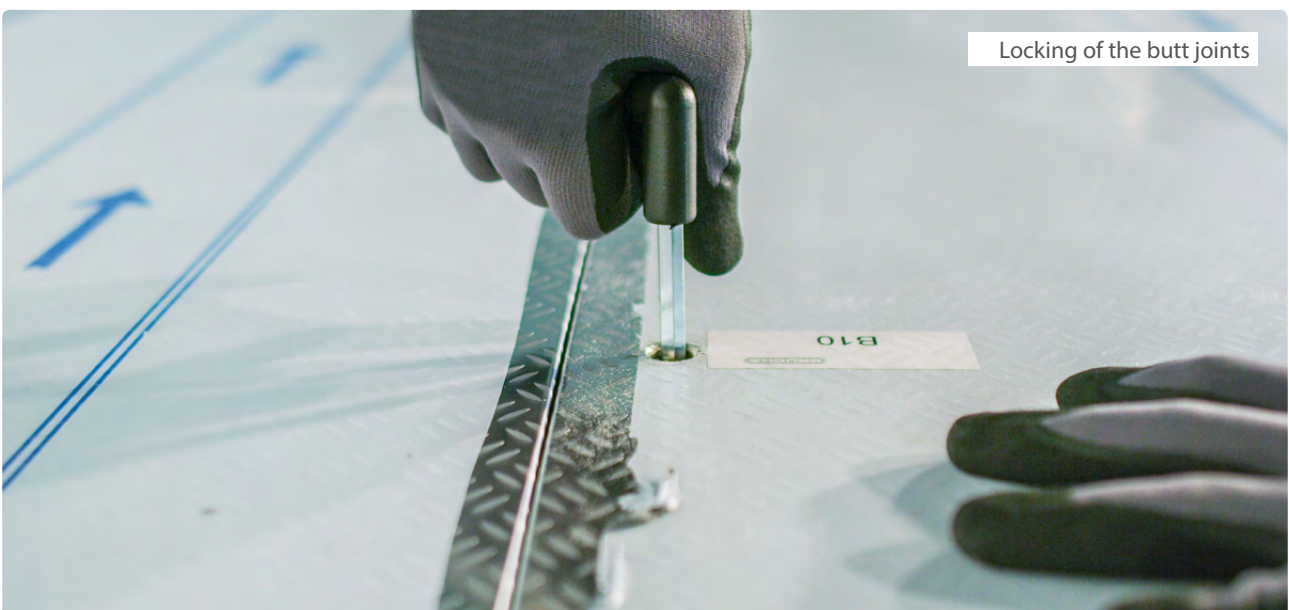
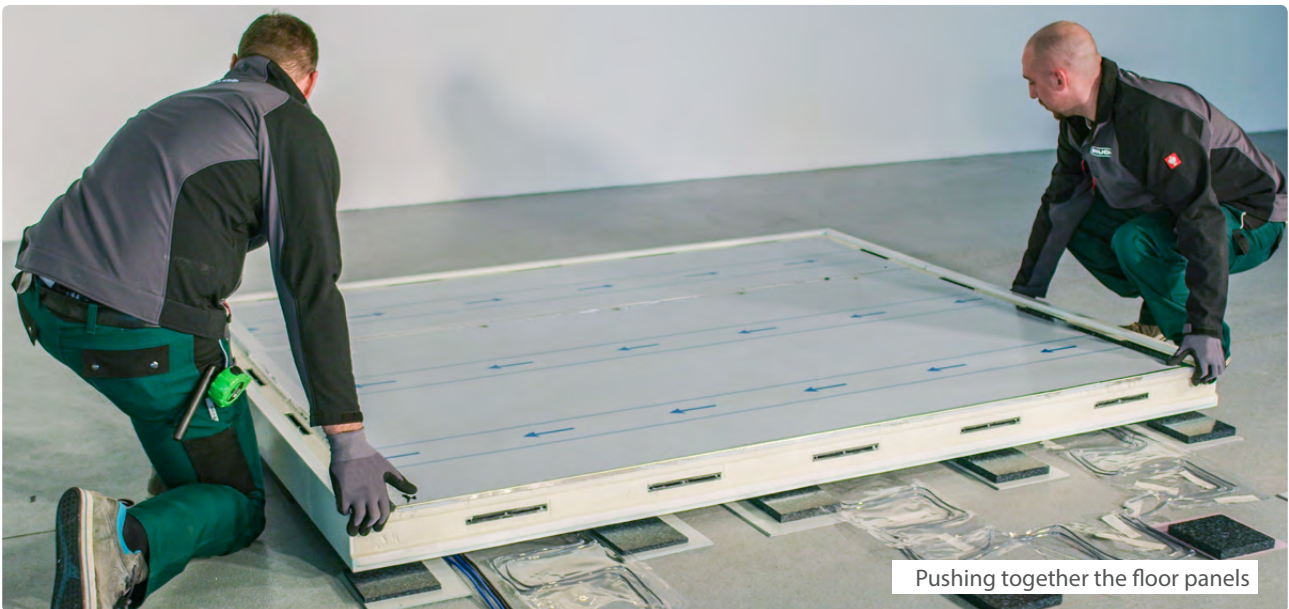



Fast-Build Walk-In **EVOLUTION**

4. Assembly of wall panels

It is best to start assembling the wall panels in a corner, as this will enable the wall to stand without any additional support. From there, work your way towards the final panel, the fitting panel. In case the given assembly situation does not allow this (e.g. if the cell is positioned in a wall recess), work your way towards the side which is accessible until the end. Check repeatedly if the wall panels are linked in a straight line; this will facilitate the later connection with the ceiling.

TIP: Here also, it is advisable to remove the protective film at the edges prior to assembly, as this facilitates the later removal.



Assembly instructions





5. Assembly of ceiling

For the ceiling, work your way from the back to the front and lock the panels in the same way as with the wall and floor panels.

TIP: Here it is recommended to already remove the protective film entirely prior to assembly!

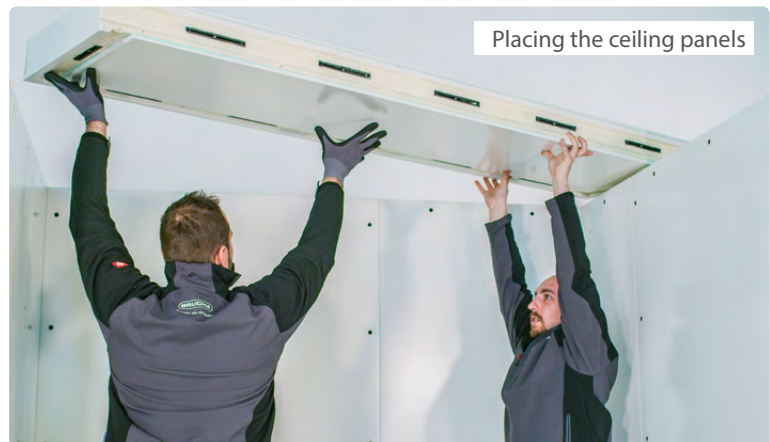

6. Remove protective film

Once all panels are in place and interlocked, you can start to remove the protective film from the walls.

TIP: Remove the protective film from the floor panels only once the work inside the cell is complete.

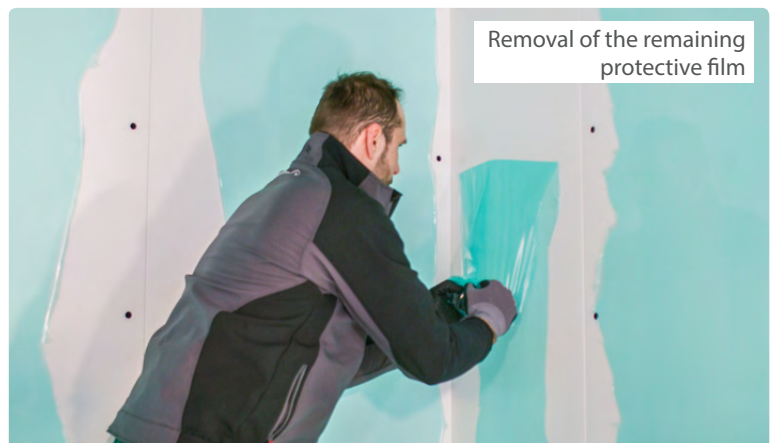

7. Cover caps

To hide the recesses of the hook locks, they are covered with the plastic caps included in the scope of delivery. Special stainless steel covers are available for stainless steel floors.

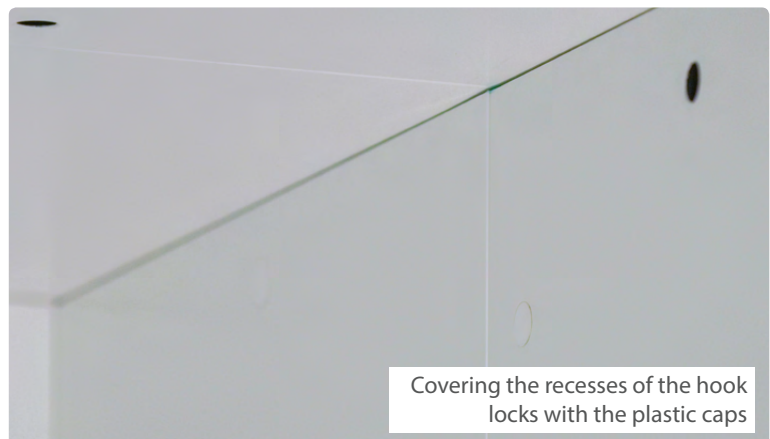

8. Seal joints (optional)

Sealing the joints is **not** required by the system; however, you can seal the joints as needed after the film has been removed.



9. Control box (optional)

In case you have laid frost heave prevention heating in the first step, you can now install the control box in an easily accessible location, usually on the front. If no heating is required in your case, you can skip this step.

Once the control box has been assembled, fasten the cable duct and route the cables through the duct to the control box. Connect the cables of the frost heave prevention heating as per the plan and attach the lid to the control box.





Fast-Build Walk-In **EVOLUTION**

10. Pressure compensation valve (standard), heating for revolving freezer door & light (both optional)

For installation, join the available cables in a socket and lay a power supply line to it, where everything is then connected. Either route this power supply line through the existing cable duct or install a second one.



11. Door and lock

You can adjust the door +/- 5 mm using the screws on the hinge. This allows you to adjust the door to ensure it closes easily. You need a screwdriver for this.



Assembly instructions

Afterwards, adjust the bracket of the door lock so that it locks properly. You need to remove the cover in order to be able to adjust the screw using a socket wrench and an SW 10 bit. Once the bracket has been adjusted properly, you can reattach the cover of the lock.





Fast-Build Walk-In **EVOLUTION**

12. Remove protective film

Once the work inside the cell is complete, you can remove the protective film from the floor panels.



13. Access ramp (optional)

Finally, position the optional access ramp.





Completed EXPRESS assembly of the EVOLUTION fast-build panel



Installation guidelines video



Company headquarters/plant:
BRUCHA Gesellschaft m.b.H
A-3451 Michelhausen - Rusterstraße 33
Tel.: +43 2275 58 75
E-mail: office@brucha.at

www.brucha.com